

AM-FINN SAUNA

The Sauna that Steams

Preferred by Architects and Builders Since 1962



HYBRID STEAM

Am-Finn's next generation steam rooms, called Hybrid Steam Rooms® (HSRs), are a highly efficient substitute to the traditional tile steam room. Compared to tile rooms, the Am-Finn HSRs® require less maintenance and less energy to operate. Traditional steam rooms harbor a variety of bacteria and mold in the grout and pores of the tile, and over a period of 3-5 years, the grout begins to deteriorate thus requiring renovation. Am-Finn's HSRs® provide many years of trouble-free service to high-traffic commercial facilities. Today, many commercial architects and facility managers have made the switch from tile to the high-tech Hybrid Steam Room®.

"Certainly lives up to it's promise...zero maintenance and the members love them!"

**- French McGee,
Hockessin Athletic Club, Hockessin, DE**



Certified Products



Preferred Vendor



Preferred Vendor



Exclusive Preferred Vendor



Preferred Vendor



Preferred Vendor

372 South Eagle Road Suite 341 Eagle Idaho USA. 83616
T: 800.237.2862 F: 208.286.0290 info@am-finn.com www.am-finn.com

Hybrid Steam and LEED

- Efficient - Am-Finn Hybrid Steam Rooms® are 50% more efficient than stone tile and 30% more efficient than ceramic tile. This translates to hundreds of dollars in savings per year.
- Sanitary - Tile and grout used in traditional steam rooms are porous and therefore harbor and promote the growth of molds and bacteria. The “musty” smell commonly associated with tile steam rooms is caused by bacteria breeding in the steam room. The acrylic interior of an Am-Finn HSR® combined with the PowerZone 400 ozone sterilizer prevents mold and bacteria from growing, leaving the HSR® clean and fresh.
- Maintenance - Traditional tile steam rooms require daily cleaning of the tile and grout in order to keep the environment clean, and within a couple years the grout will discolor and begin to deteriorate. Am-Finn HSRs® can be sprayed down with standard household cleaning products for plastic/acrylic shower enclosures.
- Installation - A traditional tile steam room can take several days to construct and can be quite costly. A typical Am-Finn HSR® can be assembled in one day and does not require costly waterproofing.
- Longevity - Am-Finn Hybrid Steam Rooms® are designed to last giving you worry-free satisfaction.



Category	LEED Credit Code
Water Efficiency	WE 3.1
Optimize Energy Performance	WE 3.2
Low-Emitting Materials	EQ 4.1
Indoor Chemical & Pollutant Source Control	EQ 5

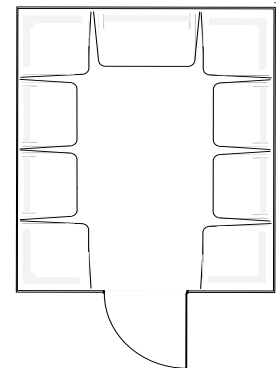
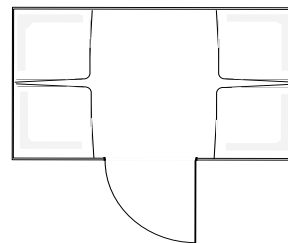
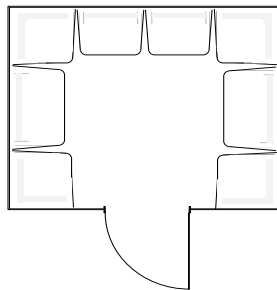

*Over 50 Layouts Available
Custom Glass Store Fronts
Integrated Seats or Multi-Tier Benches*



Certified Products



Preferred Vendor



Preferred Vendor



Exclusive Preferred Vendor



Preferred Vendor



Preferred Vendor